



# New Product Bulletin

## Sea Pro® FH240 Series Handle Kit (SP1293) Installation Instructions



# Sea Pro® FH240 Series Handle Kit (SP1293) Installation Instructions

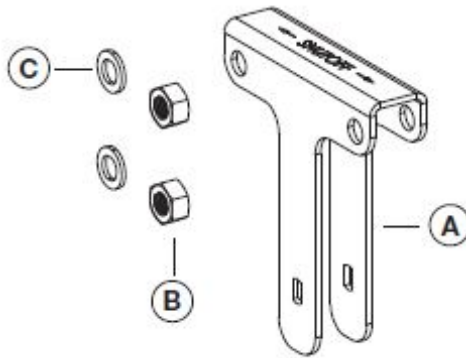

Part	Description	Quantity
A	Handle, Dual Valve	1
B	Nut, Hex M12x1.75 SS	2
C	M12 Lock Washer	2

### Torque Values

Torque		
in-lb	ft-lb	N-m
96-120	8-10	11-14

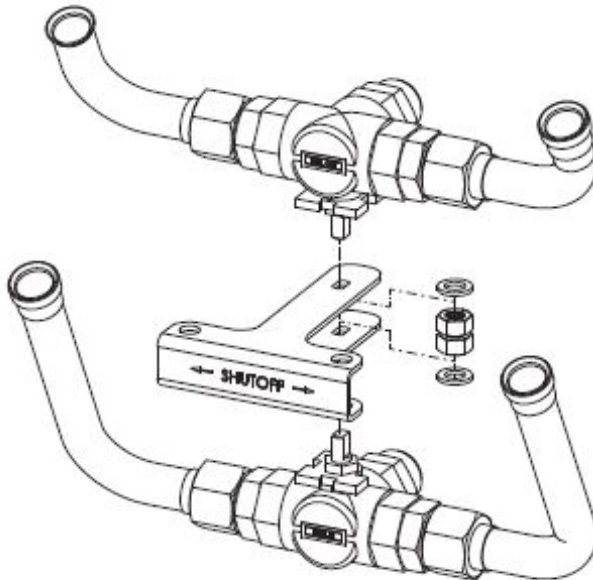

**CAUTION:** These instructions are intended for use by professional mechanics who are trained in the proper use of power and hand tools, using appropriate safety precautions (including eye protection).



[LT36440 Sea Pro FH240 Handle Kit Install v3.pdf](#) [1]

English

[Fuel Filtration](#) [2]

LT36440  
Products

