

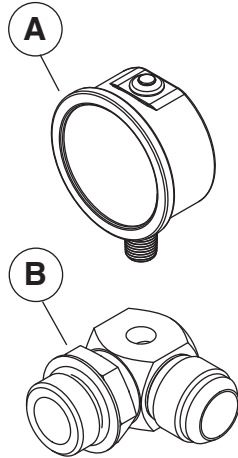

## Dual Sea Pro® Gauge Kit



## SP1531 (Compound Pressure Gauge)

Part	Description	Quantity	Part Number
A	Compound Pressure Gauge	1	SP72027
B	90° Elbow Flare Fitting	1	-

## Torque Values

Application	Torque		
	in-lb	ft-lb	N·m
Gauge to 90° Elbow Flare Fitting	180-300	15-25	20.3-33.9
90° Elbow Flare Fitting to Fuel Out Three Way Valve	1380-1632	115-136	155.9-184.4

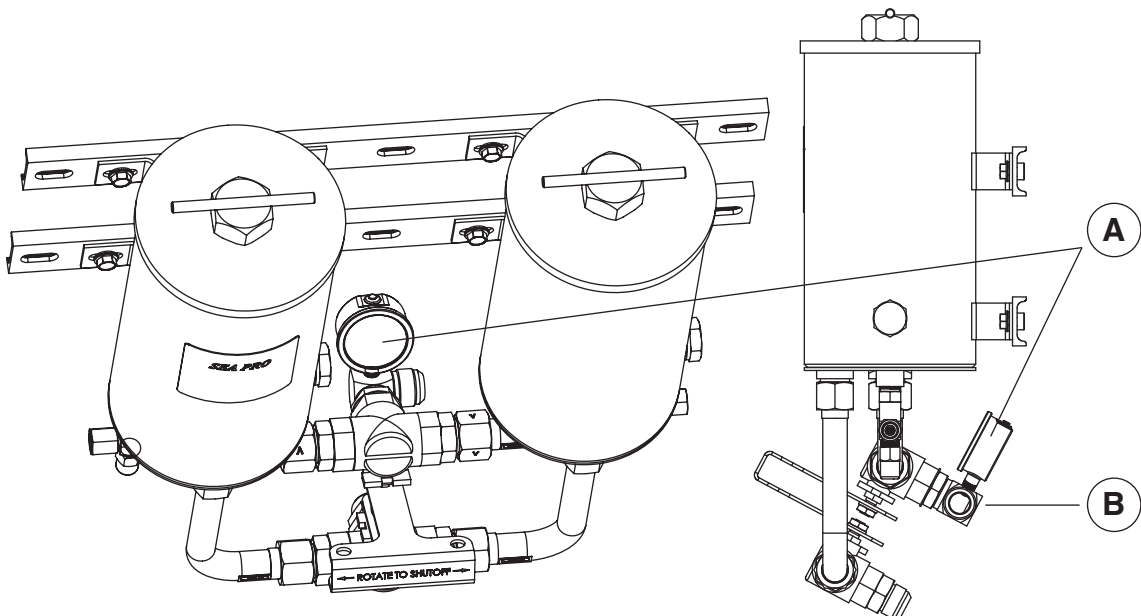

**⚠ CAUTION:** These instructions are intended for use by professional mechanics who are trained in the proper use of power and hand tools, using appropriate safety precautions (including eye protection).

## Single Sea Pro® Gauge Kit

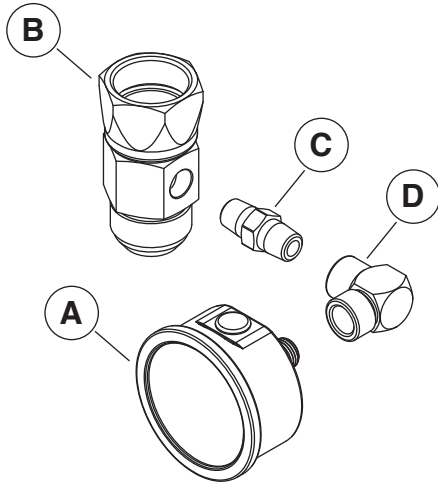

## SP1639 (Compound Pressure Gauge)

Part	Description	Quantity	Part Number
A	Compound Pressure Gauge	1	SP72036
B	Swivel Flare Fitting	1	-
C	Pipe Nipple	1	-
D	90° Elbow Fitting	1	-

## Torque Values

Application	Torque		
	in-lb	ft-lb	Nm
Gauge to 90° Elbow Fitting	180-300	15-25	20.3-33.9
Elbow Fitting to Pipe Nipple	180-300	15-25	20.3-33.9
Pipe Nipple to Swivel Flare Fitting	180-300	15-25	20.3-33.9
Swivel Flare Fitting to Fuel Out Port	1380-1632	115-136	155.9-184.4

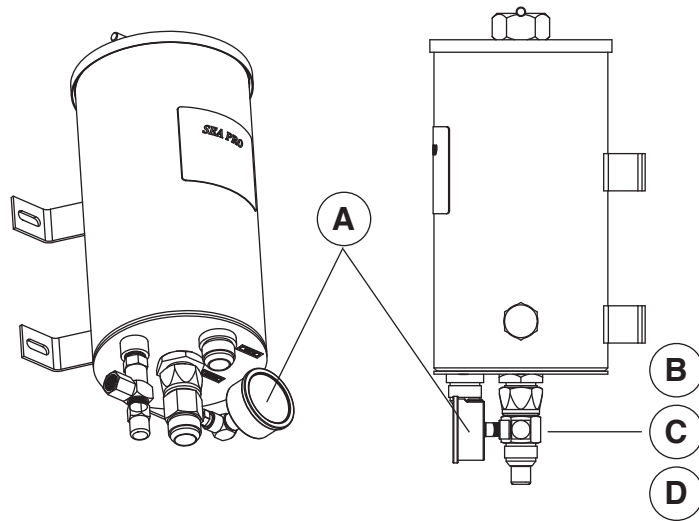

---

## Compound Pressure Gauge Installation

### Dual Unit

1. Before installation, make sure the system is not running and is drained of fuel.
2. Close off the fuel supply to the Stage 1 Sea Pro unit.
3. Clean both sides of the flare fittings, removing any dirt or debris from the threads and sealing surfaces.

**⚠ Caution:** Do not damage the sealing surface of the fittings.

4. Remove the outlet flare fitting from the three-way valve.
5. Install the 90° elbow flare fitting (B) and rotate to position and tighten.
6. Apply Teflon™ tape or pipe sealant to the thread of the compound gauge, install into the nipple flare fitting and tighten.
7. Refer to the Torque Values table (page 1) for required torque values.

**Note:** The filter must be changed once the gauge reaches a maximum limit of 4 psi (27.58 kPa).

Note: Once the gauge has been installed, follow the standard start-up procedure while priming the system with the electric priming pump.

### Single Unit

1. Before installation, make sure the system is not running and is drained of fuel.
2. Close off the fuel supply to the Stage 1 Sea Pro unit.
3. Clean both sides of the flare fittings, removing any dirt or debris from the threads and sealing surfaces.

**⚠ Caution:** Do not damage the sealing surface of the fittings.

4. Install the swivel fitting (B) to the Fuel Out port on the housing and torque as specified.
5. Apply thread sealant to the pipe nipple (C) and 90° elbow fitting (D) and thread as shown. Torque to the required position for correct alignment of the gauge.
6. Apply Teflon tape or pipe sealant to the thread of the compound gauge (A) and install into the 90° elbow fitting (D).
7. Refer to the Torque Values table (page 1) for required torque values.

**Note:** The filter must be changed once the gauge reaches a maximum limit of 4 psi (27.58 kPa).

Note: Once the gauge has been installed, follow the standard start-up procedure while priming the system with the electric priming pump.



**Filtration**

**For more information, visit  
[cumminsfiltration.com](http://cumminsfiltration.com)**

LT36507 Rev. A  
©2017 Cummins Filtration Inc.  
Printed in the U.S.A.